

Qty.	Description
1	<b>CM 5-5 A-R-A-E-AVBE F-A-A-N</b>
	<div data-bbox="223 504 534 683" data-label="Image"> </div> <div data-bbox="590 772 1077 795" data-label="Text"> <p>Note! Product picture may differ from actual product</p> </div> <div data-bbox="199 801 470 828" data-label="Text"> <p>Product No.: <a href="#">98694013</a></p> </div> <div data-bbox="199 862 1452 963" data-label="Text"> <p>Compact, reliable, horizontal, multistage, end-suction centrifugal pump with axial suction port and radial discharge port. The shaft, impellers and chambers are made of stainless steel. The inlet and discharge parts are made of cast iron. The mechanical shaft seal is a special designed, unbalanced O-ring seal. Pipework connection is via internal Whitworth pipe threads, Rp (ISO 7/1).</p> </div> <div data-bbox="199 1003 1093 1030" data-label="Text"> <p>The pump is fitted with a 3-phase, foot-mounted, fan-cooled asynchronous motor.</p> </div> <div data-bbox="199 1093 638 1153" data-label="Text"> <p><b>Controls:</b>            Frequency converter: NONE</p> </div> <div data-bbox="199 1182 702 1332" data-label="Text"> <p><b>Liquid:</b>            Pumped liquid: Water            Liquid temperature range: -20 .. 90 °C            Selected liquid temperature: 20 °C            Density: 998.2 kg/m<sup>3</sup></p> </div> <div data-bbox="199 1361 821 1534" data-label="Text"> <p><b>Technical:</b>            Pump speed on which pump data are based: 2900 rpm            Rated flow: 4.7 m<sup>3</sup>/h            Rated head: 38.61 m            Code for shaft seal: AVBE            Curve tolerance: ISO9906:2012 3B</p> </div> <div data-bbox="199 1568 742 1780" data-label="Text"> <p><b>Materials:</b>            Pump housing: Cast iron                              EN-GJL-200                              ASTM A48-25A            Impeller: Stainless steel                              EN 1.4301                              AISI 304</p> </div> <div data-bbox="199 1809 726 2072" data-label="Text"> <p><b>Installation:</b>            Range of ambient temperature: -20 .. 55 °C            Maximum operating pressure: 10 bar            Max pressure at stated temp: 10 bar / 40 °C              6 bar / 90 °C            Type of connection: Rp            Size of inlet connection: 1 1/4 inch            Size of outlet connection: 1 inch            Outlet position: 12</p> </div>

Qty.	Description
	<p><b>Electrical data:</b></p> <p>Motor standard: IEC Frame size: 80C IE efficiency class: IE3 Rated power - P2: 1.1 kW Mains frequency: 50 Hz Suitable for 50/60 Hz: N Phases: 3 Rated voltage: 220-240D/380-415Y V Service factor: 1.00 Rated current: 4,4-4,5/2,55-2,6 A Starting current: 720-780 % Rated speed: 2830-2860 rpm Enclosure class (IEC 34-5): IP55 Insulation class (IEC 85): F Built-in motor protection: NONE</p> <p><b>Others:</b></p> <p>Terminal box position: 12 Minimum efficiency index, MEI <math>\eta_{\%}</math>: 0.7 Net weight: 15.5 kg Gross weight: 18 kg Approvals: CE,WRAS,ACS,TR,EAC</p>

Description	Value
<b>General information:</b>	
Product name:	CM 5-5 A-R-A-E-AVBE F-A-A-N
Product No:	98694013
EAN number:	5712600021631 5712600021631
<b>Technical:</b>	
Pump speed on which pump data are based:	2900 rpm
Rated flow:	4.7 m <sup>3</sup> /h
Rated head:	38.61 m
Impellers:	5
Code for shaft seal:	AVBE
Curve tolerance:	ISO9906:2012 3B
Pump version:	A
Model:	A
<b>Materials:</b>	
Pump housing:	Cast iron EN-GJL-200 ASTM A48-25A
Impeller:	Stainless steel EN 1.4301 AISI 304
Material code:	A
Code for rubber:	E
<b>Installation:</b>	
Range of ambient temperature:	-20 .. 55 °C
Maximum operating pressure:	10 bar
Max pressure at stated temp:	10 bar / 40 °C 6 bar / 90 °C
Type of connection:	Rp
Size of inlet connection:	1 1/4 inch
Size of outlet connection:	1 inch
Outlet position:	12
Connect code:	R
<b>Liquid:</b>	
Pumped liquid:	Water
Liquid temperature range:	-20 .. 90 °C
Selected liquid temperature:	20 °C
Density:	998.2 kg/m <sup>3</sup>
<b>Electrical data:</b>	
Motor standard:	IEC
Frame size:	80C
IE efficiency class:	IE3
Rated power - P2:	1.1 kW
Mains frequency:	50 Hz
Suitable for 50/60 Hz:	N
Phases:	3
Rated voltage:	220-240D/380-415Y V
Service factor:	1.00
Rated current:	4,4-4,5/2,55-2,6 A
Starting current:	720-780 %
Rated speed:	2830-2860 rpm
Enclosure class (IEC 34-5):	IP55
Insulation class (IEC 85):	F
Built-in motor protection:	NONE
<b>Controls:</b>	
Frequency converter:	NONE
<b>Others:</b>	

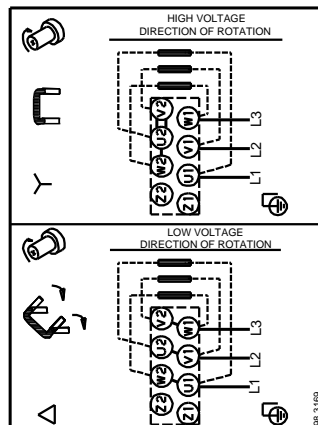

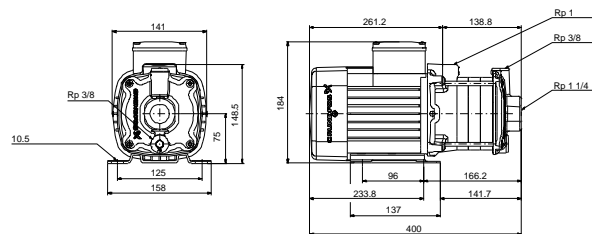
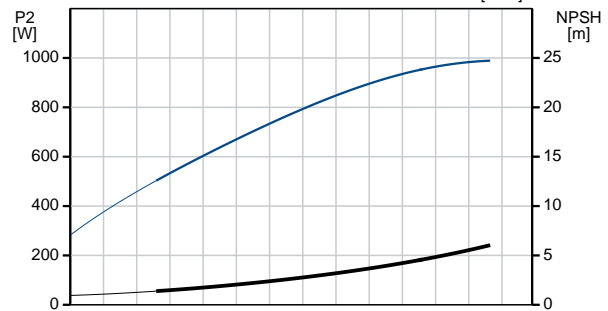
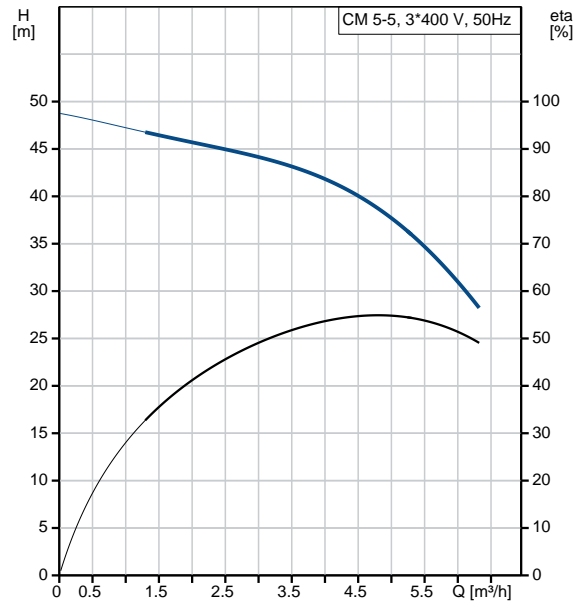

Company name:

Created by:

Phone:

Date:

03/04/2020

Description	Value
Terminal box position:	12
Minimum efficiency index, MEI %:	0.7
Net weight:	15.5 kg
Gross weight:	18 kg
Approvals:	CE,WRAS,ACS,TR,EAC