

Qty.	Description
1	<p data-bbox="199 336 558 369">CM 5-6 O-R-I-E-AQQE C-A-A-N</p> <div data-bbox="287 448 502 571" style="text-align: center;">  </div> <p data-bbox="199 660 470 694">Product No.: 98482189</p> <p data-bbox="199 716 1452 817">Compact, reliable, horizontal, multistage, end-suction centrifugal pump with axial suction port and radial discharge port. The pump is self-priming and can create a suction lift of up to 8 metres. Pump materials in contact with the liquid are in stainless steel. The mechanical shaft seal is a special designed, unbalanced O-ring seal. Pipework connection is via internal Whitworth pipe threads, Rp (ISO 7/1).</p> <p data-bbox="199 862 1093 896">The pump is fitted with a 1-phase, foot-mounted, fan-cooled asynchronous motor.</p> <p data-bbox="199 952 319 985">Controls:</p> <p data-bbox="199 974 638 1008">Frequency converter: NONE</p> <p data-bbox="199 1041 295 1075">Liquid:</p> <p data-bbox="199 1064 638 1097">Pumped liquid: Water</p> <p data-bbox="199 1097 670 1131">Liquid temperature range: 0 .. 60 °C</p> <p data-bbox="199 1131 630 1164">Selected liquid temperature: 20 °C</p> <p data-bbox="199 1164 702 1198">Density: 998.2 kg/m³</p> <p data-bbox="199 1220 327 1254">Technical:</p> <p data-bbox="199 1243 821 1276">Pump speed on which pump data are based: 2900 rpm</p> <p data-bbox="199 1276 662 1310">Rated flow: 4.7 m³/h</p> <p data-bbox="199 1310 662 1344">Rated head: 45.88 m</p> <p data-bbox="199 1344 638 1377">Code for shaft seal: AQQE</p> <p data-bbox="199 1377 766 1411">Curve tolerance: ISO9906:2012 3B</p> <p data-bbox="199 1411 614 1444">Self priming: 8 m</p> <p data-bbox="199 1456 327 1489">Materials:</p> <p data-bbox="199 1489 726 1579">Pump housing: Stainless steel EN 1.4301 AISI 304</p> <p data-bbox="199 1579 726 1668">Impeller: Stainless steel EN 1.4301 AISI 304</p> <p data-bbox="199 1691 343 1724">Installation:</p> <p data-bbox="199 1724 694 1758">Range of ambient temperature: -20 .. 55 °C</p> <p data-bbox="199 1758 638 1792">Maximum operating pressure: 16 bar</p> <p data-bbox="199 1792 726 1848">Max pressure at stated temp: 16 bar / 60 °C 16 bar / 60 °C</p> <p data-bbox="199 1848 598 1881">Type of connection: Rp</p> <p data-bbox="199 1881 630 1915">Size of inlet connection: 1 inch</p> <p data-bbox="199 1915 630 1948">Size of outlet connection: 1 inch</p> <p data-bbox="199 1948 598 1982">Outlet position: 12</p> <p data-bbox="199 1993 383 2027">Electrical data:</p> <p data-bbox="199 2027 614 2060">Motor standard: IEC</p> <p data-bbox="199 2060 614 2094">Frame size: 90A</p> <p data-bbox="199 2094 646 2128">Rated power - P2: 1.3 kW</p>



Company name:

Created by:

Phone:

Date:

29/04/2020

Qty.	Description
	Mains frequency: 50 Hz
	Suitable for 50/60 Hz: N
	Phases: 1
	Rated voltage: 220-240 V
	Service factor: 1.00
	Rated current: 8.4-8.0 A
	Starting current: 340-340 %
	Rated speed: 2710 rpm
	Enclosure class (IEC 34-5): IP55
	Insulation class (IEC 85): F
	Built-in motor protection: PTO
	Others:
	Terminal box position: 12
	Minimum efficiency index, MEI $\eta_{\%}$: 0.7
	Net weight: 22.9 kg
	Gross weight: 25.4 kg
	Approvals: CE,WRAS,ACS,TR,EAC
	Country of origin: HU
	Custom tariff no.: 84137075

Description	Value
General information:	
Product name:	CM 5-6 O-R-I-E-AQQE C-A-A-N
Product No:	98482189
EAN number:	5711495880880 5711495880880
Price:	1.069,00 EUR
Technical:	
Pump speed on which pump data are based:	2900 rpm
Rated flow:	4.7 m³/h
Rated head:	45.88 m
Impellers:	6
Code for shaft seal:	AQQE
Curve tolerance:	ISO9906:2012 3B
Pump version:	O
Model:	A
Self priming:	8 m
Materials:	
Pump housing:	Stainless steel EN 1.4301 AISI 304
Impeller:	Stainless steel EN 1.4301 AISI 304
Material code:	I
Code for rubber:	E
Installation:	
Range of ambient temperature:	-20 .. 55 °C
Maximum operating pressure:	16 bar
Max pressure at stated temp:	16 bar / 60 °C 16 bar / 60 °C
Type of connection:	Rp
Size of inlet connection:	1 inch
Size of outlet connection:	1 inch
Outlet position:	12
Connect code:	R
Liquid:	
Pumped liquid:	Water
Liquid temperature range:	0 .. 60 °C
Selected liquid temperature:	20 °C
Density:	998.2 kg/m³
Electrical data:	
Motor standard:	IEC
Frame size:	90A
Rated power - P2:	1.3 kW
Mains frequency:	50 Hz
Suitable for 50/60 Hz:	N
Phases:	1
Rated voltage:	220-240 V
Service factor:	1.00
Rated current:	8.4-8.0 A
Starting current:	340-340 %
Rated speed:	2710 rpm
Enclosure class (IEC 34-5):	IP55
Insulation class (IEC 85):	F
Built-in motor protection:	PTO
Controls:	
Frequency converter:	NONE

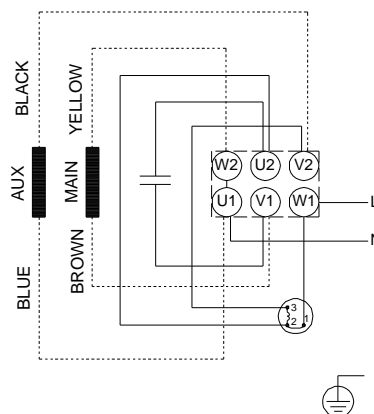
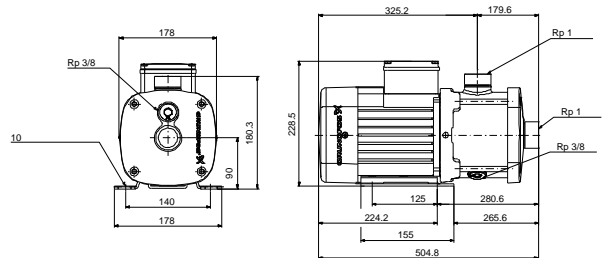
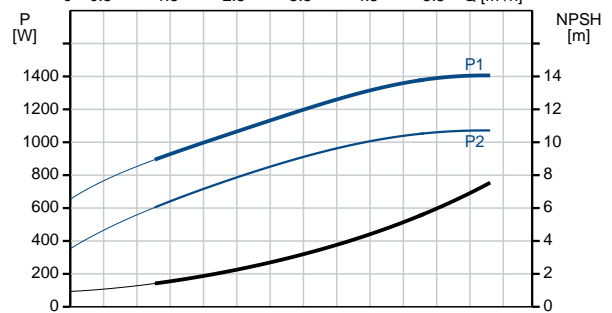
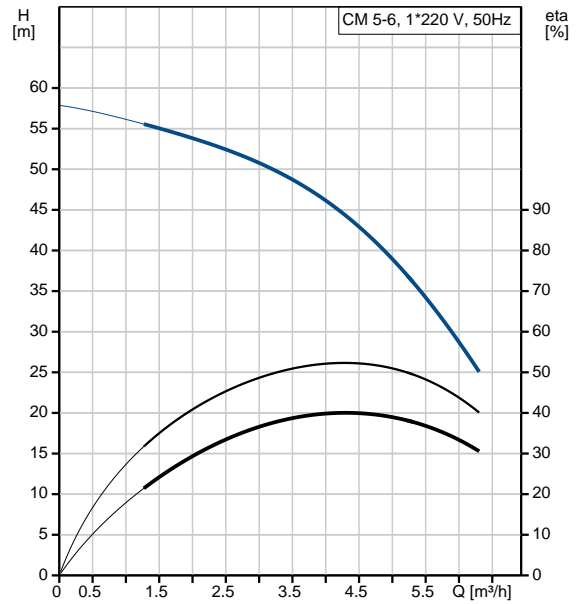



Company name:

Created by:

Phone:

Date:

29/04/2020

Description	Value
Others:	
Terminal box position:	12
Minimum efficiency index, MEI %:	0.7
Net weight:	22.9 kg
Gross weight:	25.4 kg
Approvals:	CE,WRAS,ACS,TR,EAC
Country of origin:	HU
Custom tariff no.:	84137075